



SPARE PART LIST

Spare Part ItemCode	Item name.	PictureId
6260.00002.05	ADJUSTABLE LEG M6	10
2854.N20.04000290.G.10	FRONT PANEL FOR 40'S GAS BAIN MARIE	13
6222.00006.42	DRAIN TAP R3/4"	20
6260.00058.96	FLUE COVER CAST IRON WITH CERAMIC ENAMEL COATED FOR ALL 700&900	21
6267.00029.05	PIEZZO IGNITER	22
2179.09028.01	LABEL FOR FRONT PANEL "ÖZT RYAK LER"	23
6267.00005.03	GAS VALVE MAX-MIN ADJUSTMENT WITH THERMOCOUPLE SAFE ECA CLAMP	25
6260.00015.46	THERMOPLASTIC KNOB MAIN BODY WITH 8 mm INSERT	26
6260.00015.40	THERMOPLASTIC KNOB SCALE MAX.-MIN FLAME-LIGHTING	27
6267.00002.62	BURNER TUBE S/S 400 mm LENGTH	36
6234.00001.21	Safety Thermostat	47
6226.00011.20	IGNITER COVER SILICONE	50
6267.00024.05	THERMOCOUPLE 8/1 x 8/1 600 mm LENGTH	57
2KLP.460.626700006.05	MAIN BURNER NOZZLE M8x0,75 ANY GAS TYPE	58
6267.00031.02	IGNITER PORCELAIN WITH CABLE FOR GAS BAINMARIE	59



DİKKAT: BU DÖKÜMANIN COĞALTILMASI, İNTERNET ORTAMINDA DOLAŞTIRILMASI VE BU ÇİZİMLER DOĞRULUSUNDA ÜRETİMİN YAPILMASI ÖZTİRYAKİLER FİRMASININ ONAYI İLE OLABİLİR. TÜM HAKLARIMIZ SAKLIDIR.

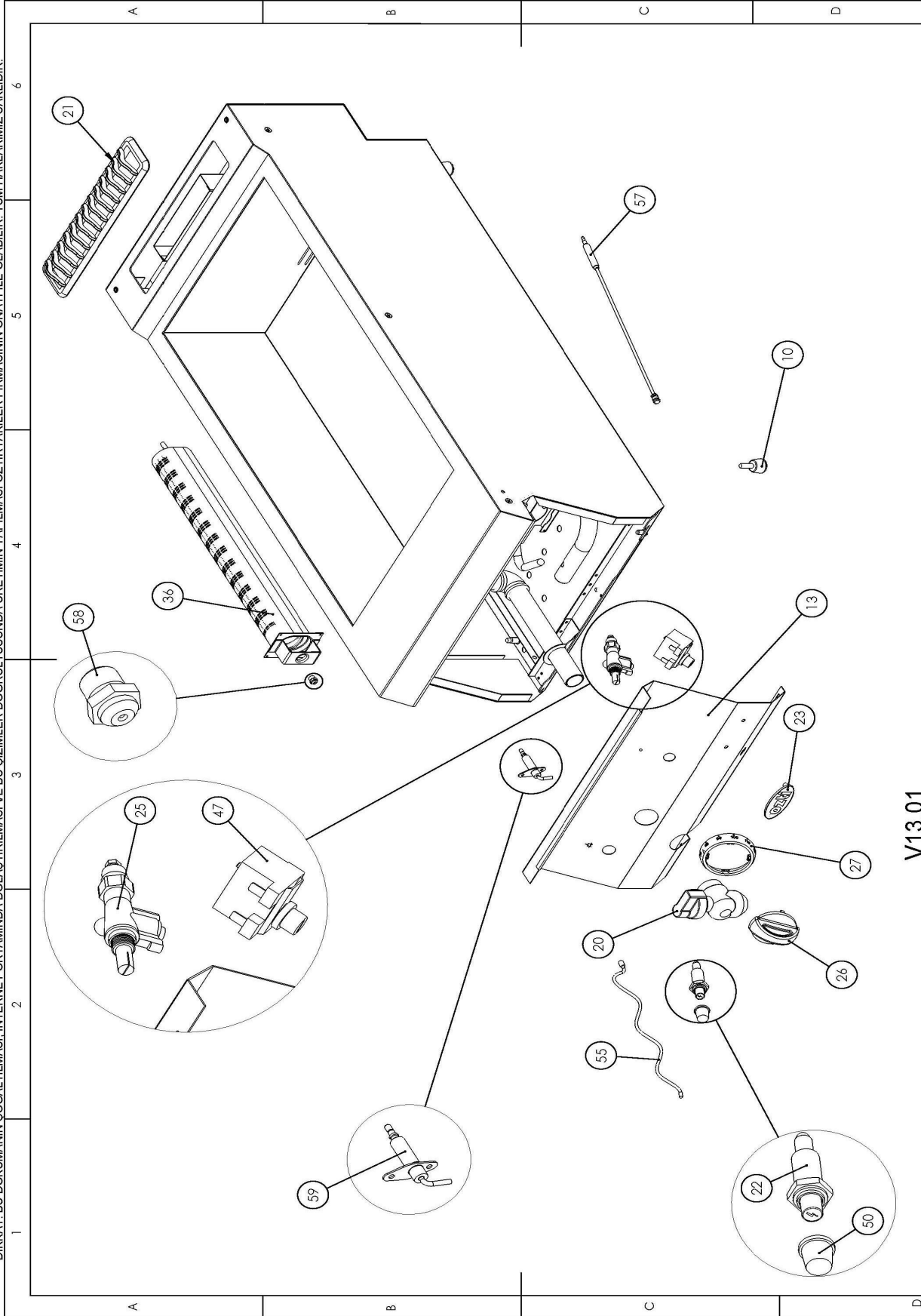

V13.01

R&D		BİSMİ	İMZA	TARİHİ	MATERYAL	TOLERANS
ÇİZEN	E.BAŞTUĞ			27.01.2012		DIN 7168 ORTA
KONTROL	M.HACI			27.01.2012		PARÇA ADI:
ONAY	M.HACI			27.01.2012		T.RESİM NO
REVİZYON		KALINLIK		ÖLÇEK		T.RESİM NO
REVİZYON		25269.33		1/6		OBG 4090 servis

ARGE
KONTROLLÜ KOPYA

V13.01

RESİM ÜZERİNDEN ÖLÇÜ ALMAYINIZ !

TÜM ÖLÇÜLER mm ÇİNSİNDİR

WARNING: IT IS APPROPRIATE TO MULTIPLY, USE, DISPLAY AT COMPUTER/INTERNET AND PRODUCE THE PRODUCT WITH ITS DRAWINGS WITH THE APPROVAL OF ÖZTİRYAKİLER COMPANY. ALL RIGHTS RESERVED.